

INSTRUMENTS AND ACCESSORIES FOR CRYO SURGERY

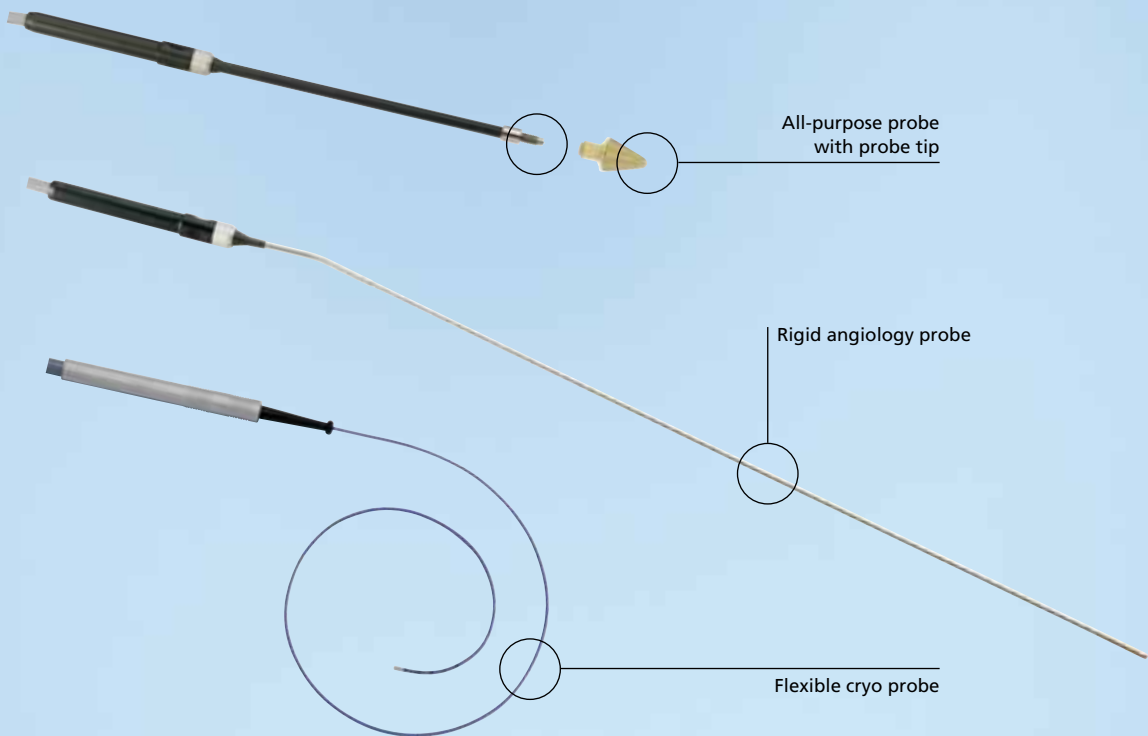

Important notes

The authors and ERBE Elektromedizin GmbH have taken the greatest possible care while compiling the catalogue with electrosurgical accessories. Nevertheless, it is impossible to exclude the possibility that errors may be contained herein.

The information and recommendations given here may not be construed as constituting any basis for any claims against ERBE Elektromedizin GmbH. Should legal regulations stipulate liability, such liability shall be limited to intentional misconduct or gross negligence.

The data on the use of instruments is based on clinical experience. Medical science is subject to a process of permanent change based on research and clinical experience. Therefore the products are subject to alterations in design and technique. Because of production tolerances dimensions in the catalogue may marginally differ.

We confirm that none of our products contain latex, except the rubber straps, Art. No. 20592-009 and 20592-011.

Please read carefully the corresponding notes on use before using any instrument.

Further product information

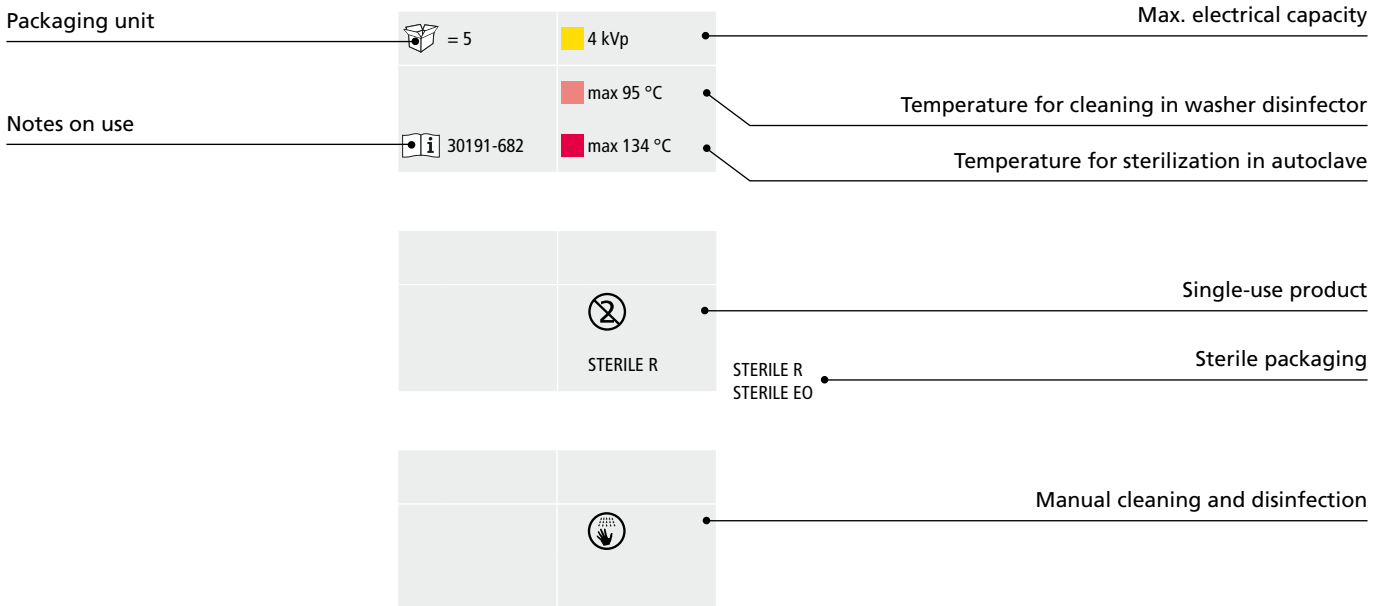

Cryo surgery

Instruments and accessories

| | |
|-------------------------------|----|
| Cryo probes for ERBOKRYO CA | 04 |
| Probe tips for ERBOKRYO CA | 08 |
| Cryo probes for ERBOKRYO AE | 11 |
| Probe tips for ERBOKRYO 12 | 15 |
| Applicators for ERBOKRYO DERM | 18 |

Overview

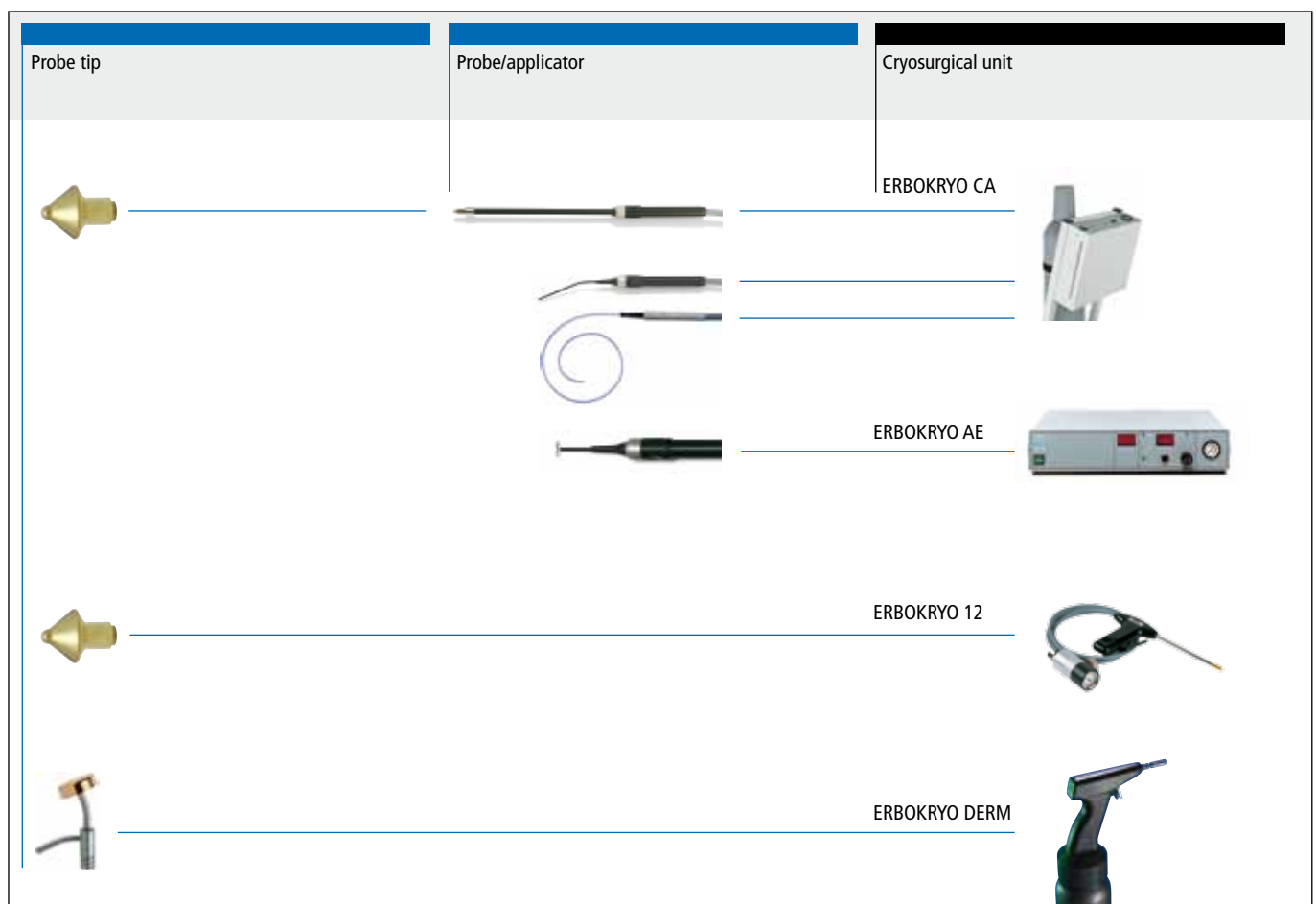

Instruments and accessories

Cryo probes for ERBOKRYO CA

Cryoprobe R4L5



e.g. for ENT

No. 20416-000

= 1



30416-058

max 134 °C

Cryoprobe R3L5



e.g. for ENT

No. 20416-001

= 1



30416-058

max 134 °C

Cryoprobe R2L2



e.g. for ENT

No. 20416-002

= 1



30416-058

max 134 °C

Cryoprobe F11



e.g. for ENT

No. 20416-003

= 1



30416-058

max 134 °C

Cryoprobe R5L10



e.g. for ENT

No. 20416-004

= 1



30416-058

max 134 °C

Cryo probes for ERBOKRYO CA

Cryoanalgesia probe, trocar, angled, Ø 0.3 mm



e.g. for spine surgery

| | |
|----------------------|------------|
| No. 20446-003 | |
| = 1 | |
| 30416-058 | max 134 °C |

Angiology probe, Ø 1.5 mm, length 80 mm



for cryostripping

| | |
|----------------------|------------|
| No. 20447-000 | |
| = 1 | |
| 30416-058 | max 134 °C |

Angiology probe, Ø 2.5 mm, length 200 mm



for cryostripping

| | |
|----------------------|------------|
| No. 20447-002 | |
| = 1 | |
| 30416-058 | max 134 °C |

Angiology probe, Ø 3.5 mm, length 550 mm



for cryostripping

| | |
|----------------------|------------|
| No. 20447-004 | |
| = 1 | |
| 30416-058 | max 134 °C |

Bronchoscopy probe, Ø 3 mm, length 530 mm



for rigid bronchoscopy

| | |
|----------------------|------------|
| No. 20447-005 | |
| = 1 | |
| 30416-058 | max 134 °C |

Cryo probes for ERBOKRYO CA

Flexible cryo probe, Ø 2.4 mm, length 900 mm

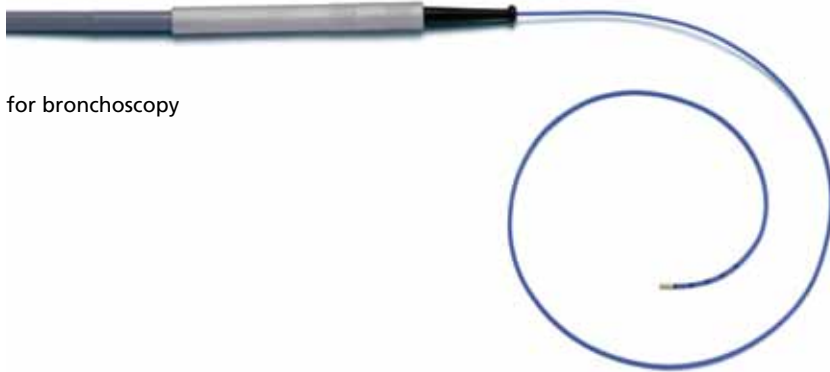

for bronchoscopy

No. 20416-032



= 1



30416-158

max 95 °C

max 134 °C

Flexible cryo probe, Ø 2.4 mm, length 780 mm

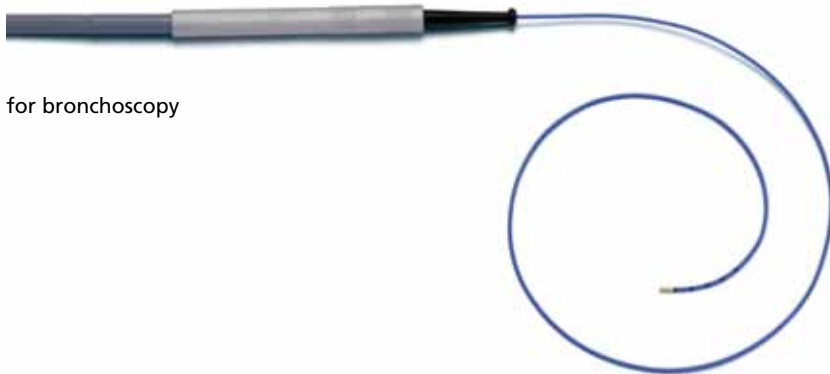

for bronchoscopy

No. 20416-033



= 1



30416-158

max 95 °C

max 134 °C

Cryo probes for ERBOKRYO CA

Flexible cryo probe, Ø 1.9 mm, length 900 mm

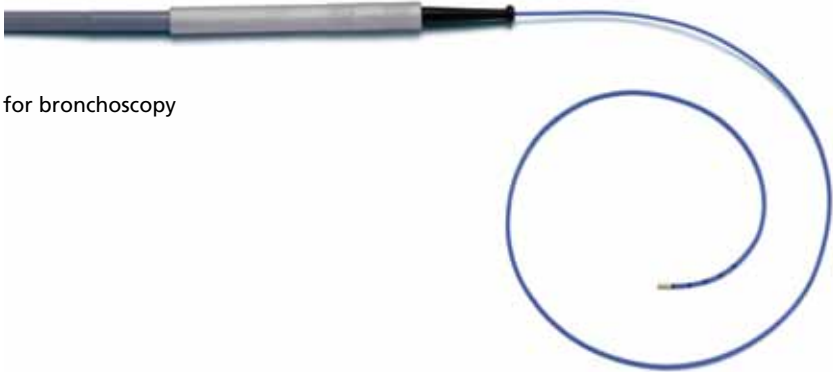

for bronchoscopy

| No. 20416-037 | |
|---------------|------------|
| = 1 | |
| | max 95 °C |
| 30416-158 | max 134 °C |

Flexible cryo probe, Ø 1.9 mm, length 780 mm

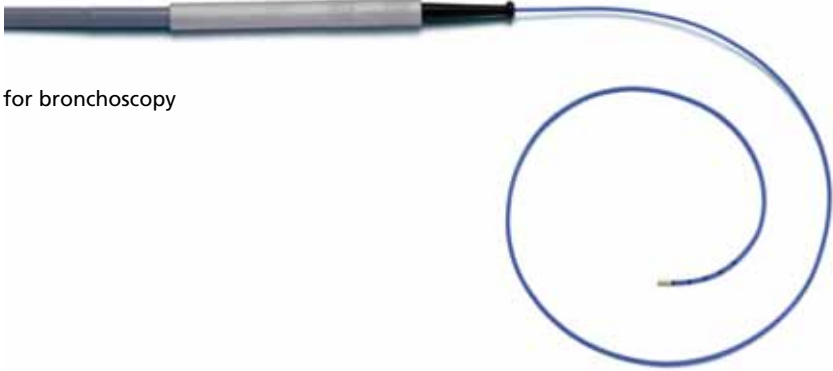

for bronchoscopy

| No. 20416-038 | |
|---------------|------------|
| = 1 | |
| | max 95 °C |
| 30416-158 | max 134 °C |

Connecting adapter for flexible cryoprobes

for ERBOKRYO CA and AE



| No. 20416-034 | |
|---------------|--|
| = 1 | |
| | |
| 30416-157 | |

Probe tips for ERBOKRYO CA

All purpose probe, length 180 mm



incl. tip 20420-012

No. 20416-006

= 1

30420-041



max 134 °C

All purpose probe, length 60 mm



incl. tip 20420-012

No. 20416-005

= 1

30420-041



max 134 °C

Cryoprobe tip, Ø 3 x 2.6 mm

e.g. for dermatology



No. 20420-010

= 1

30420-041

max 95 °C

max 134 °C

Cryoprobe tip, conical, Ø 9.5 mm

e.g. for dermatology



No. 20420-012

= 1

30420-041

max 95 °C

max 134 °C

Cryoprobe tip, oval, Ø 9.5 mm

e.g. for dermatology



No. 20420-013

= 1

30420-041

max 95 °C

max 134 °C

Probe tips for ERBOKRYO CA

Cryoprobe tip, Ø 19 mm



e.g. for potop ectopy

| | |
|----------------------|------------|
| No. 20420-014 | |
| = 1 | |
| | max 95 °C |
| 30420-041 | max 134 °C |

Cryoprobe tip, Ø 19 mm



e.g. for potop ectopy

| | |
|----------------------|------------|
| No. 20420-015 | |
| = 1 | |
| | max 95 °C |
| 30420-041 | max 134 °C |

Cryoprobe tip, flat, Ø 19 mm



e.g. for proctology or dermatology

| | |
|----------------------|------------|
| No. 20420-016 | |
| = 1 | |
| | max 95 °C |
| 30420-041 | max 134 °C |

Cryoprobe tip, Ø 19 mm



e.g. for potop ectopy

| | |
|----------------------|------------|
| No. 20420-020 | |
| = 1 | |
| | max 95 °C |
| 30420-041 | max 134 °C |

Cryoprobe tip, Ø 21 mm



e.g. for potop ectopy

| | |
|----------------------|------------|
| No. 20420-021 | |
| = 1 | |
| | max 95 °C |
| 30420-041 | max 134 °C |

Probe tips for ERBOKRYO CA

Cryoprobe tip, Ø 23 mm



e.g. for potop ectopy

No. 20420-022



= 1



30420-041

max 95 °C

max 134 °C

Cryoprobe tip, Ø 25 mm



e.g. for potop ectopy

No. 20420-023



= 1



30420-041

max 95 °C

max 134 °C

Cryoprobe tip, Ø 18 mm



e.g. for potop ectopy

No. 20420-024



= 1



30420-041

max 95 °C

max 134 °C

Accessories for ERBOKRYO CA

No.

| | |
|--|------------------|
| One pedal foot switch, explosion-proof | 20711-008 |
| One pedal foot switch, non explosion-proof | 20711-009 |
| Cylinder cover for N ₂ O cylinders (german standard) | 20410-039 |
| Sterilizing box for cryo probes, small | 20410-034 |
| Sterilizing box for cryo probes, large | 20410-035 |
| Gas hose N ₂ O, length 0.7 m | 20448-000 |
| Gas filter N ₂ O (R 3/8") | 20410-006 |
| Gas hose CO ₂ , length 1 m | 20410-004 |
| Gas filter for CO ₂ (W 21,8 x 1/14") | 20410-010 |
| Filter cartridges (set) | 20410-008 |
| Gas cylinder connector for N ₂ O (german standard) | 20410-001 |
| Gas cylinder connector (UK, Greece) (11/16" x 20) | 20410-002 |
| Gas cylinder connector for CO ₂ (german standard) | 20410-003 |
| Gas cylinder connector (GB, F, USA) pin index 3+5 for N ₂ O | 20410-005 |
| Gas cylinder connector (GUS) M 22 x 1,5 | 20410-013 |
| Gas cylinder connector (Russia) for CO ₂ (M 26 x 1,5) | 20410-016 |
| Gas cylinder connector (GB, F, USA) pin index 1+6 for CO ₂ | 20410-011 |
| Gas cylinder connector (CGA) 326 (G1/2") | 20410-014 |
| Gas cylinder connector (F) (M 26 x 1,5) | 20410-037 |
| Handle for all purpose probes | 20416-007 |